

Cambridge Brass
P.O. Box 249
140 Orion Place
Cambridge, Ontario
Canada N1R 5V1
Tel: (519) 621-5520
Fax: (519) 621-8674
<http://www.cambridgebrass.com>

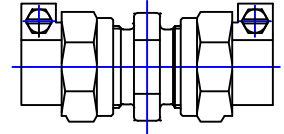

MODEL NO. 118NL

CAMPAK x CAMPAK

COUPLING
WITH INTERNAL STOPS

FOR COPPER OR PLASTIC (CTS) TUBING

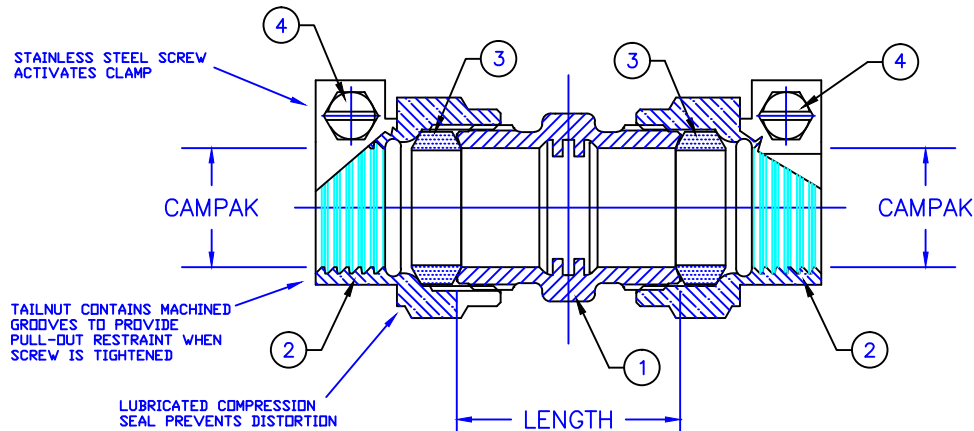

PARTS AND MATERIAL:

1. COUPLING BODY: CAST BRASS, ALLOY C89833
2. CAMPAK NUT: CAST BRASS, ALLOY C83600
3. COMPRESSION SEAL: NITRILE RUBBER
4. SCREW: STAINLESS STEEL, TYPE 304

FEATURES:

- CONFORMS TO AWWA C800 (ASTM B584 UNS C89833 FOR ALL BRASS PARTS IN CONTACT WITH POTABLE WATER)
- CONFORMS TO ANSI/NSF 61-8
- CONFORMS TO ANSI/NSF 372 (COMPLIANT WITH US Safe Drinking Water Act. PL 111-380)
- BODY AND NUTS PROVIDE WRENCH FLATS FOR INSTALLATION
- BODY PROVIDES INTERNAL TUBE STOPS.
- 300PSI WORKING PRESSURE

Cambridge Brass considers the information in this submittal form to be correct at the time of publication. Item and option availability, including specifications, are subject to change without notice.

CATALOG NO.	CAMPACK SIZE	CAMPACK SIZE	LENGTH	APPROX. WT. LBS.
118NL-B2B1	5/8"	1/2"	2.10"	1.0
118NL-B3B1	3/4"	1/2"	1.90"	1.0
118NL-B3B2	3/4"	5/8"	1.92"	1.0
118NL-B3B3	3/4"	3/4"	1.93"	1.0
118NL-B4B3	1"	3/4"	2.10"	1.4
118NL-B4B4	1"	1"	2.12"	1.5
118NL-B5B5	1 1/4"	1 1/4"	3.07"	2.1
118NL-B6B6	1 1/2"	1 1/2"	2.78"	3.7
118NL-B7B7	2"	2"	3.04"	5.3

Submitted by:

Cambridge Brass
P.O. Box 249
140 Orion Place
Cambridge, Ontario
Canada N1R 5V1
Tel: (519) 621-5520
Fax: (519) 621-8674
<http://www.cambridgebrass.com>

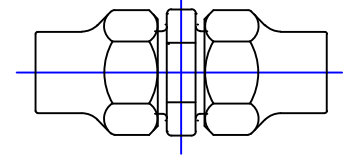

MODEL NO. 118NL

COPPER FLARE x COPPER FLARE

COUPLING

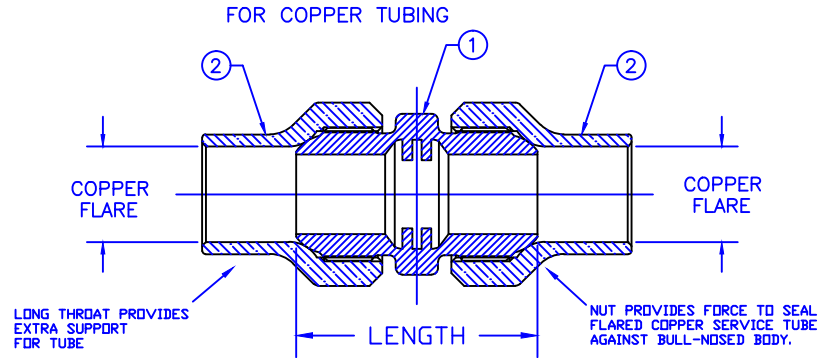

PARTS AND MATERIAL:
1. BODY: CAST BRASS, ALLOY C89833
2. COPPER FLARE NUT: CAST BRASS, ALLOY C83600

FEATURES:

- CONFORMS TO AWWA C800 (ASTM B584 UNS C89833 FOR ALL BRASS PARTS IN CONTACT WITH POTABLE WATER)
- CONFORMS TO ANSI/NSF 61-8
- CONFORMS TO ANSI/NSF 372 (COMPLIANT WITH US Safe Drinking Water Act. PL 111-380)
- BODY AND NUTS PROVIDE WRENCH FLATS FOR INSTALLATION
- 300PSI WORKING PRESSURE

ORDERING INFORMATION:
LESS NUT = ADD "LN" TO END OF CATALOG NO.

Cambridge Brass considers the information in this submittal form to be correct at the time of publication. Item and option availability, including specifications, are subject to change without notice.

CATALOG NO.	COPPER FLARE SIZE	COPPER FLARE SIZE	LENGTH	APPROX. WT. LBS.
118NL-C1C1	1/2"	1/2"	2.36"	0.8
118NL-C2C1	5/8"	1/2"	2.28"	0.9
118NL-C2C2	5/8"	5/8"	2.28"	1.2
118NL-C3C1	3/4"	1/2"	2.28"	1.1
118NL-C3C2	3/4"	5/8"	2.28"	1.1
118NL-C3C3	3/4"	3/4"	2.51"	1.2
118NL-C4C3	1"	3/4"	2.43"	1.6
118NL-C4C4	1"	1"	2.58"	1.9
118NL-C5C5	1 1/4"	1 1/4"	3.19"	3.8
118NL-C6C6	1 1/2"	1 1/2"	3.69"	5.1
118NL-C7C7	2"	2"	4.84"	8.5

Submitted by:

Cambridge Brass
P.O. Box 249
140 Orion Place
Cambridge, Ontario
Canada N1R 5V1
Tel: (519) 621-5520
Fax: (519) 621-8674
http://www.cambridgebrass.com

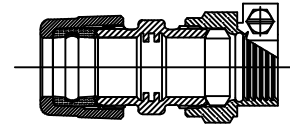

MODEL NO. 118NL

CB COMPRESSION x CAMPAK

COUPLING
WITH INTERNAL STOPS

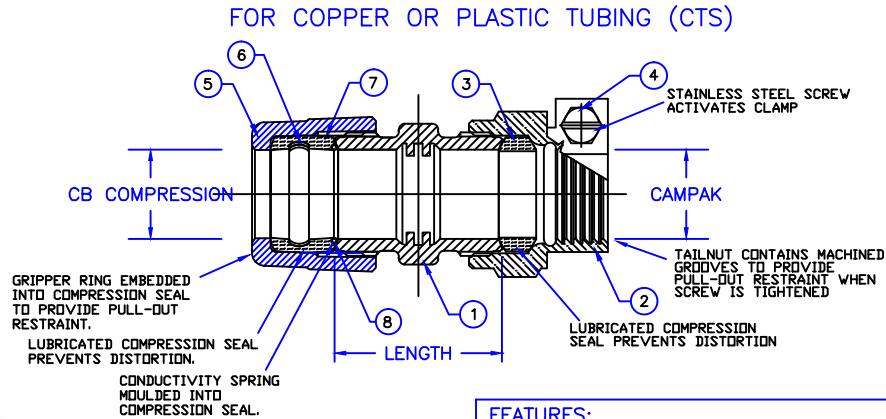

PARTS AND MATERIAL:

1. COUPLING BODY: NO LEAD CAST BRASS, ALLOY C89833
2. CAMPAK NUT: CAST BRASS, ALLOY C83600
3. COMPRESSION SEAL: NITRILE RUBBER
4. SCREW: STAINLESS STEEL, TYPE 304
5. COMPRESSION NUT: CAST BRASS, ALLOY C83600
6. GRIPPER: STAINLESS STEEL, TYPE 302
7. COMPRESSION SEAL: EPDM
8. CONDUCTOR SPRING: BRASS

FEATURES:

- CONFORMS TO AWWA C800 (ASTM B584 UNS C89833 FOR ALL BRASS PARTS IN CONTACT WITH POTABLE WATER)
- CONFORMS TO ANSI/NSF 61-8
- CONFORMS TO ANSI/NSF 372 (COMPLIANT WITH US Safe Drinking Water Act. PL 111-380)
- BODY AND NUTS PROVIDE WRENCH FLATS FOR INSTALLATION
- BODY PROVIDES INTERNAL TUBE STOPS.
- 300PSI WORKING PRESSURE

Cambridge Brass considers the information in this submittal form to be correct at the time of publication. Item and option availability, including specifications, are subject to change without notice.

CATALOG NO.	CB SIZE	CAMPAK SIZE	LENGTH	APPROX. WT. LBS.
118NL-H1B1	1/2"	1/2"	1.93"	1.0
118NL-H2B1	5/8"	1/2"	2.10"	1.0
118NL-H3B1	3/4"	1/2"	1.90"	1.0
118NL-H3B2	3/4"	5/8"	1.92"	1.0
118NL-H3B3	3/4"	3/4"	1.93"	1.0
118NL-H4B1	1"	1/2"	3.67"	2.4
118NL-H4B2	1"	5/8"	2.03"	1.2
118NL-H4B3	1"	3/4"	2.10"	1.4
118NL-H4B4	1"	1"	2.12"	1.5
118NL-H5B5	1 1/4"	1 1/4"	3.07"	2.1
118NL-H6B4	1 1/2"	1"	2.35"	2.1
118NL-H6B6	1 1/2"	1 1/2"	2.78"	3.7
118NL-H7B7	2"	2"	3.04"	5.3

Submitted by:

Cambridge Brass
P.O. Box 249
140 Orion Place
Cambridge, Ontario
Canada N1R 5V1
Tel: (519) 621-5520
Fax: (519) 621-8674
<http://www.cambridgebrass.com>

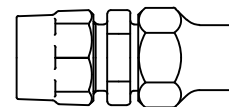

MODEL NO. 118NL

CB COMPRESSION x COPPER FLARE

COUPLING
WITH INTERNAL STOPS

FOR COPPER AND PLASTIC (CTS) TUBING

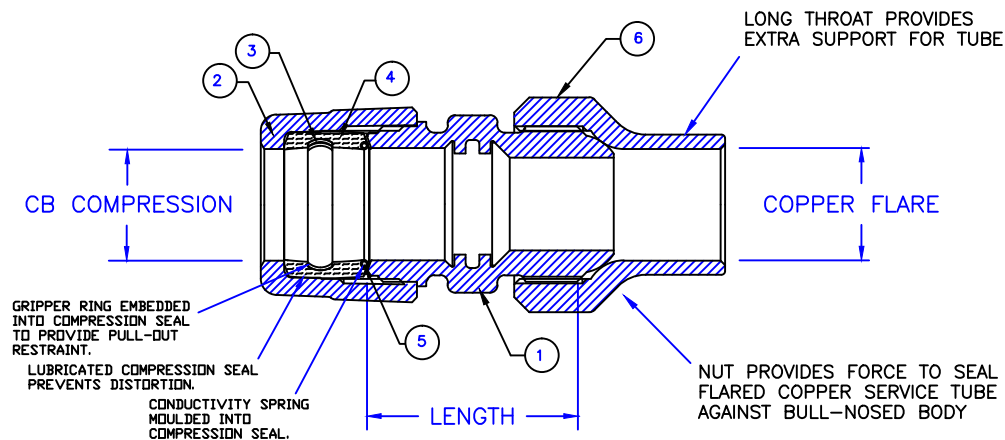

PARTS AND MATERIAL:

1. COUPLING BODY: NO LEAD CAST BRASS, ALLOY C89833
2. COMPRESSION NUT: CAST BRASS, ALLOY C83600
3. GRIPPER: STAINLESS STEEL, TYPE 302
4. COMPRESSION SEAL: EPDM
5. CONDUCTOR SPRING: BRASS
6. COPPER FLARE NUT: CAST BRASS, ALLOY C83600

FEATURES:

- CONFORMS TO AWWA C800 (ASTM B584 UNS C89833 FOR ALL BRASS PARTS IN CONTACT WITH POTABLE WATER)
- CONFORMS TO ANSI/NSF 61-8
- CONFORMS TO ANSI/NSF 372 (COMPLIANT WITH US Safe Drinking Water Act. PL 111-380)
- BODY AND NUTS PROVIDE WRENCH FLATS FOR INSTALLATION
- BODY PROVIDES INTERNAL TUBE STOPS.
- 300PSI WORKING PRESSURE

Cambridge Brass considers the information in this submittal form to be correct at the time of publication. Item and option availability, including specifications, are subject to change without notice.

CATALOG NO.	CB COMPRESSION	COPPER FLARE	LENGTH	APPROX. WT. LBS.
118NL-H3C1	3/4"	1/2"	2.22"	
118NL-H3C3	3/4"	3/4"	2.22"	
118NL-H3C4	3/4"	1"	2.28"	
118NL-H5C5	1 1/4"	1 1/4"	3.07"	
118NL-H6C4	1 1/2"	1"	2.35"	
118NL-H6C7	1 1/2"	2"	3.58"	

Submitted by:

Cambridge Brass
P.O. Box 249
140 Orion Place
Cambridge, Ontario
Canada N1R 5V1
Tel: (519) 621-5520
Fax: (519) 621-8674
<http://www.cambridgebrass.com>

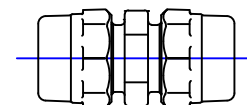

MODEL NO. 118NL

CB COMPRESSION x CB COMPRESSION

COUPLING
WITH INTERNAL STOPS

FOR COPPER OR PLASTIC TUBING (CTS)

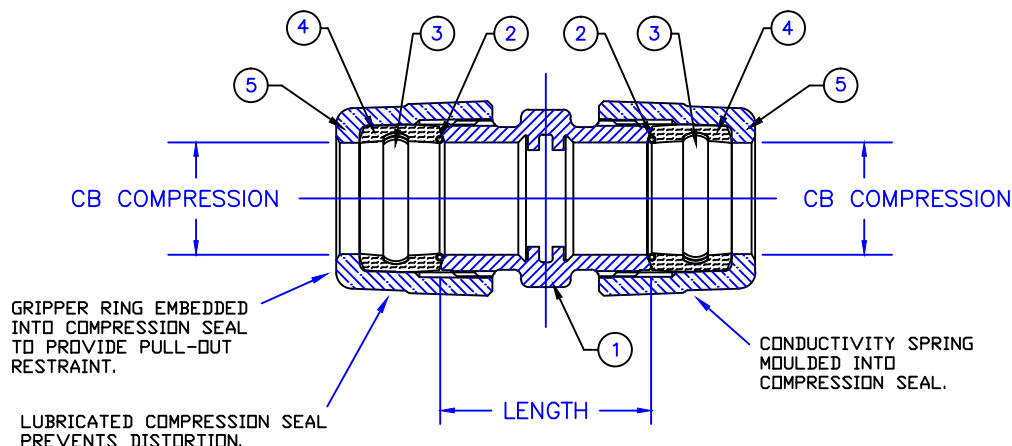

PARTS AND MATERIAL:

1. COUPLING BODY: NO LEAD CAST BRASS, ALLOY C89833
2. CONDUCTOR SPRING: BRASS
3. GRIPPER: STAINLESS STEEL, TYPE 302
4. COMPRESSION SEAL: EPDM
5. COMPRESSION NUT: CAST BRASS, ALLOY C83600

FEATURES:

- CONFORMS TO AWWA C800 (ASTM B584 UNS C89833 FOR ALL BRASS PARTS IN CONTACT WITH POTABLE WATER)
- CONFORMS TO ANSI/NSF 61-8
- CONFORMS TO ANSI/NSF 372 (COMPLIANT WITH US Safe Drinking Water Act. PL 111-380)
- BODY AND NUTS PROVIDE WRENCH FLATS FOR INSTALLATION
- BODY PROVIDES INTERNAL TUBE STOPS.
- 300PSI WORKING PRESSURE

Cambridge Brass considers the information in this submittal form to be correct at the time of publication. Item and option availability, including specifications, are subject to change without notice.

CATALOG NO.	CB COMPRESSION	CB COMPRESSION	LENGTH	APPROX. WT. LBS.
118NL-H1H1	1/2"	1/2"	1.93"	0.9
118NL-H2H1	5/8"	1/2"	1.79"	0.8
118NL-H2H2	5/8"	5/8"	1.64"	0.7
118NL-H3H1	3/4"	1/2"	1.93"	0.9
118NL-H3H2	3/4"	5/8"	1.79"	0.8
118NL-H3H3	3/4"	3/4"	1.93"	1.0
118NL-H4H2	1"	5/8"	2.03"	1.2
118NL-H4H3	1"	3/4"	2.13"	1.5
118NL-H4H4	1"	1"	2.13"	1.7
118NL-H5H5	1 1/4"	1 1/4"	3.07"	3.7
118NL-H6H4	1 1/2"	1"	2.35"	2.3
118NL-H6H6	1 1/2"	1 1/2"	3.00"	3.1
118NL-H7H7	2"	2"	3.04"	4.0

Submitted by:

Cambridge Brass
P.O. Box 249
140 Orion Place
Cambridge, Ontario
Canada N1R 5V1
Tel: (519) 621-5520
Fax: (519) 621-8674
<http://www.cambridgebrass.com>

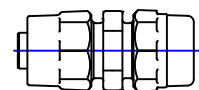

MODEL NO. 118NL

KITEC x CB COMPRESSION

COUPLING
WITH INTERNAL STOPS

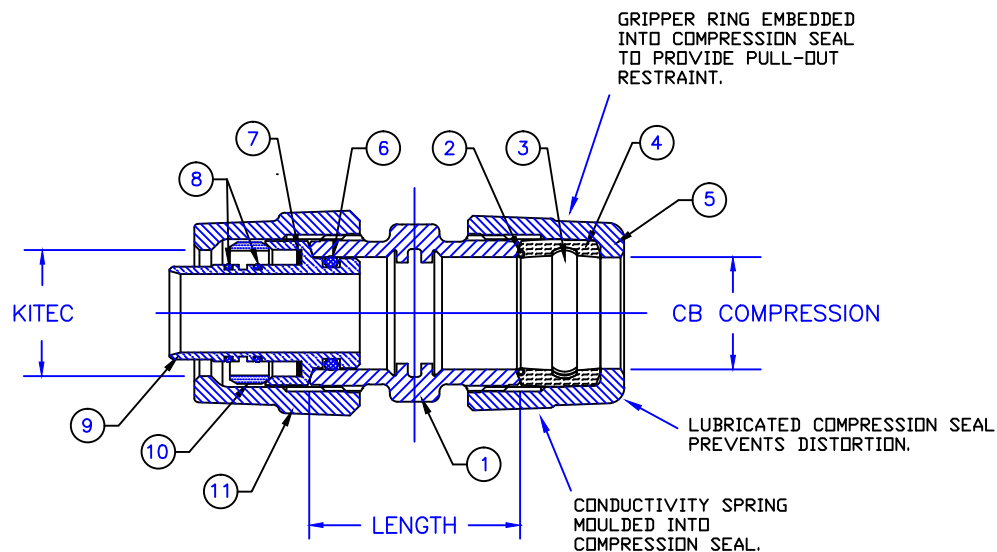

PARTS AND MATERIAL:

1. COUPLING BODY: CAST BRASS, ALLOY C89833
2. CONDUCTOR SPRING: BRASS
3. GRIPPER: STAINLESS STEEL, TYPE 302
4. COMPRESSION SEAL: EPDM
5. COMPRESSION NUT: CAST BRASS, ALLOY C83600
6. O-RING: NITRILE RUBBER
7. INSULATOR: POLYETHYLENE
8. O-RING: NITRILE RUBBER
9. INSERT: CAST BRASS, ALLOY C89833
10. GRIPPER: BRASS, ALLOY C51000
11. KITEC NUT: CAST BRASS, ALLOY C83600

FEATURES:

- CONFORMS TO AWWA C800 (ASTM B584 UNS C89833 FOR ALL BRASS PARTS IN CONTACT WITH POTABLE WATER)
- CONFORMS TO ANSI/NSF 61-8
- CONFORMS TO ANSI/NSF 372 (COMPLIANT WITH US Safe Drinking Water Act. PL 111-380)
- BODY AND NUTS PROVIDE WRENCH FLATS FOR INSTALLATION
- BODY PROVIDES INTERNAL TUBE STOPS.
- 300PSI WORKING PRESSURE

Cambridge Brass considers the information in this submittal form to be correct at the time of publication. Item and option availability, including specifications, are subject to change without notice.

CATALOG NO.	KITEC	CB COMPRESSION	LENGTH	APPROX. WT. LBS.
118NL-K3H3	3/4"	3/4"	1.93"	1.1
118NL-K3H4	3/4"	1"	2.10"	1.6
118NL-K4H3	1"	3/4"	2.10"	1.6
118NL-K4H4	1"	1"	2.12"	1.9

Submitted by:

Cambridge Brass
P.O. Box 249
140 Orion Place
Cambridge, Ontario
Canada N1R 5V1
Tel: (519) 621-5520
Fax: (519) 621-8674
<http://www.cambridgebrass.com>

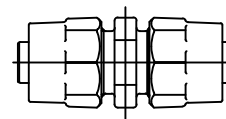

MODEL NO. 118NL

KITEC x KITEC

COUPLING
WITH INTERNAL STOPS

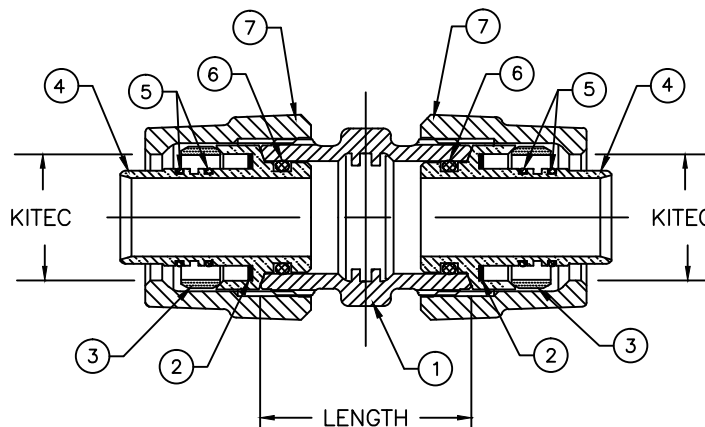

PARTS AND MATERIAL:

1. COUPLING BODY: CAST BRASS, ALLOY C89833
2. INSULATOR: POLYETHYLENE
3. GRIPPER: BRASS, ALLOY C51000
4. INSERT: CAST BRASS, ALLOY C89833
5. O-RING: NITRILE RUBBER
6. O-RING: NITRILE RUBBER
7. KITEC NUT: CAST BRASS, ALLOY C83600

FEATURES:

- CONFORMS TO AWWA C800 (ASTM B584 UNS C89833 FOR ALL BRASS PARTS IN CONTACT WITH POTABLE WATER)
- CONFORMS TO ANSI/NSF 61-8
- CONFORMS TO ANSI/NSF 372 (COMPLIANT WITH US Safe Drinking Water Act, PL 111-380)
- BODY AND NUTS PROVIDE WRENCH FLATS FOR INSTALLATION
- BODY PROVIDES INTERNAL TUBE STOPS.
- 300PSI WORKING PRESSURE

Cambridge Brass considers the information in this submittal form to be correct at the time of publication. Item and option availability, including specifications, are subject to change without notice.

CATALOG NO.	KITEC SIZE	KITEC SIZE	LENGTH	APPROX. WT. LBS.
118NL-K3K3	3/4"	3/4"	1.93"	1.2
118NL-K4K3	1"	3/4"	2.10"	1.7
118NL-K4K4	1"	1"	2.12"	1.9

Submitted by: